

Technical data

Column qty	3
Max Loading capacity	150KG
Height range	580-1230mm

Accessory list

Attention: The drawings below are only for reference which might be slightly different from the actual object, please in kind prevail. Any tools missing or installation problems, please contact the customer service firstly.

No.	Image	Spec	Qty
A		M6	6
B		M6	8
C		M6	16
D		M6	12
E		M8	4
F		St4.2	24
G		St4.2	6
H		Wiring fixing seat	6
I		Wrench 4x4mm Wrench (with cross) 5x5mm	1

Component list

No.	Part	Qty	No.	Part	Qty
①	 Pedestal pad	3	②	 Lifting column	3
No.	Part	Qty	No.	Part	Qty
③	 Supporting beam	2	④	 Supporting plate	3
No.	Part	Qty	No.	Part	Qty
⑤	 Left connecting plate	1	⑥	 Right connecting plate	1
No.	Part	Qty	No.	Part	Qty
⑦	 Control box	1	⑧	 Hand Switch (Option)	1
No.	Part	Qty	No.	Part	Qty
⑨	 Power Plug	1	⑩	 Cable	1

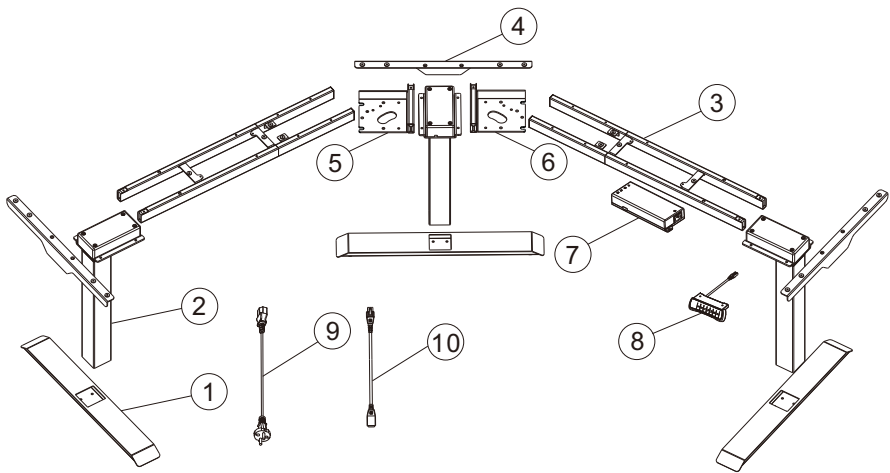

Note: This standing desk has three angle installation methods, namely 90 °, 120 ° and 180 °

STEP 1

Install left and right connecting plates

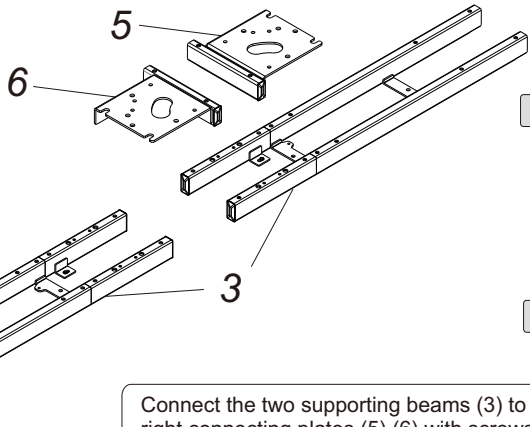

Connect the two supporting beams (3) to the left and right connecting plates (5) (6) with screws (C) and (E) respectively. There are three angles to choose at will, and finally tighten them with a wrench (I)

90° Installation

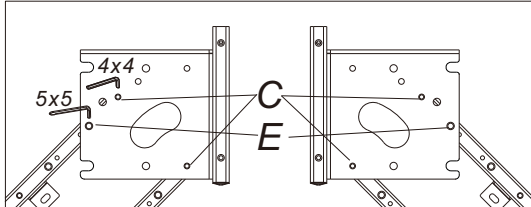

120° Installation

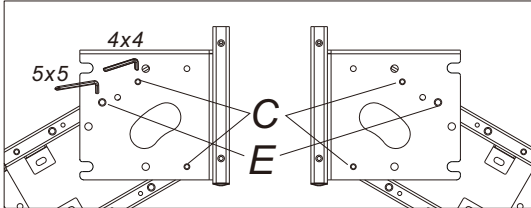

180° Installation

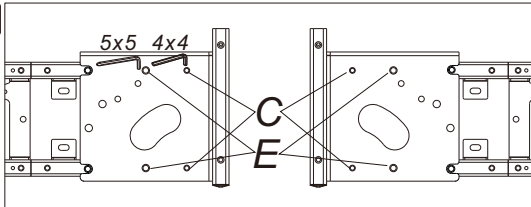

STEP 2

Install lifting columns



120° Installation

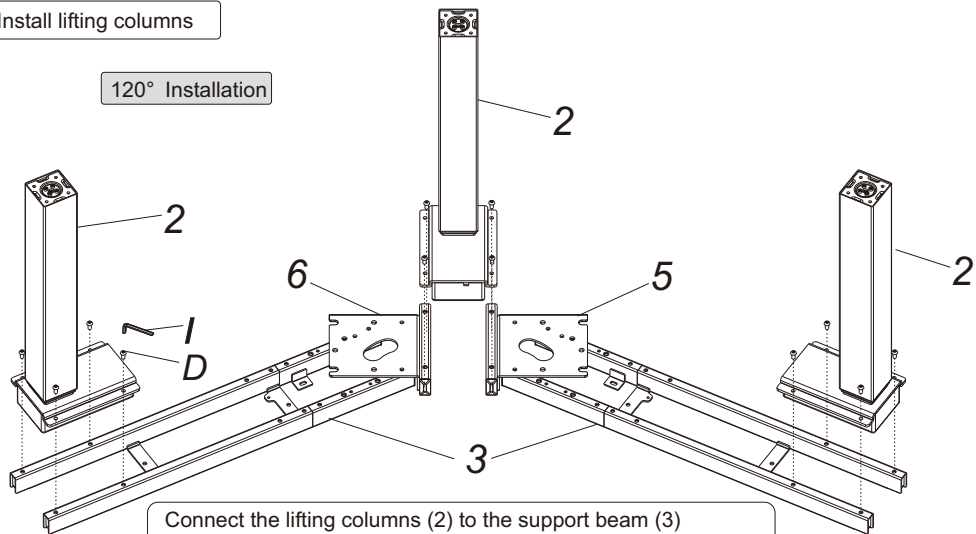

Connect the lifting columns (2) to the support beam (3) with screws (D), the middle column (2) to the left and right connecting plates (5) (6), and the wrench (I) to tighten the screws; 90° and 180° are installed in the same way as 120°.

STEP 3-1

Install the Feet



90° and 120° installation

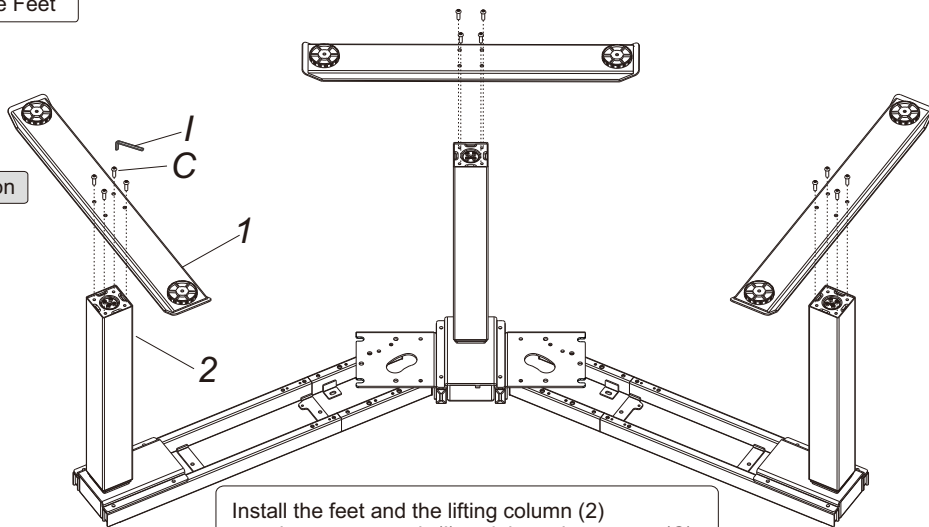

Install the feet and the lifting column (2) together, use wrench (I) to tighten the screws (C).

STEP 3-2

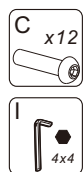

180° Installation

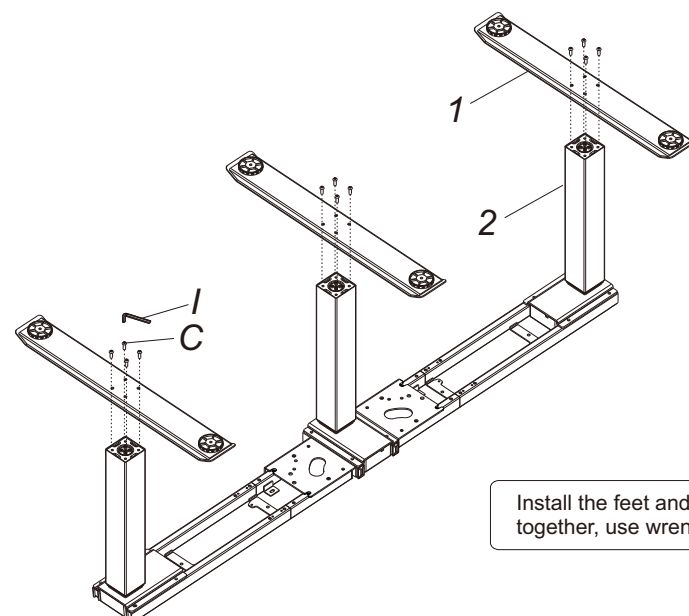

Install the feet and the lifting column (2) together, use wrench (I) to tighten the screws (C).

STEP 4

Install the supporting plate



120° Installation

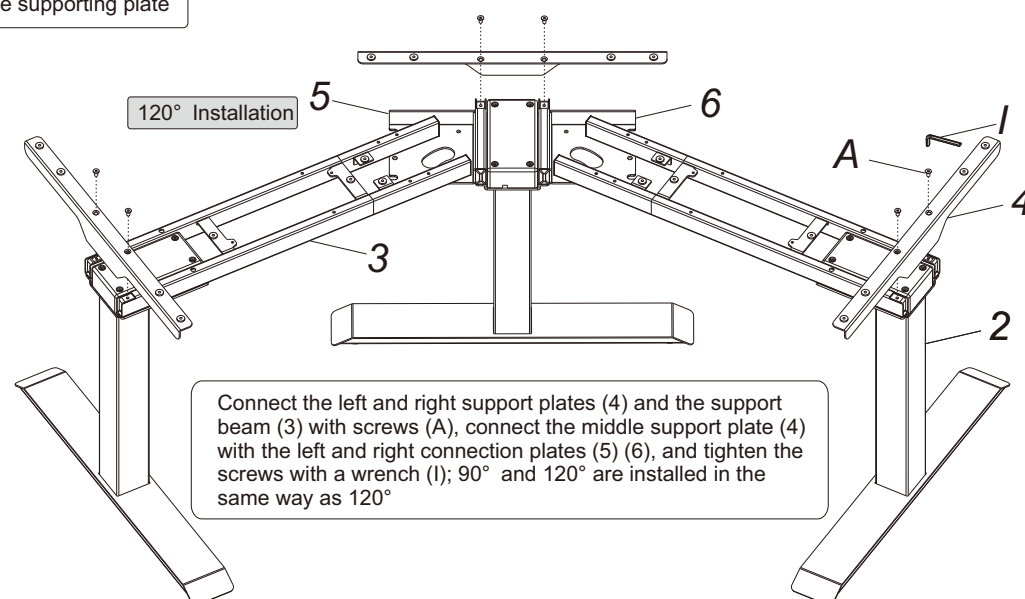

Connect the left and right support plates (4) and the support beam (3) with screws (A), connect the middle support plate (5) with the left and right connection plates (6), and tighten the screws with a wrench (I); 90° and 120° are installed in the same way as 120°

STEP 5

Connect All the Cables onto the Control Box

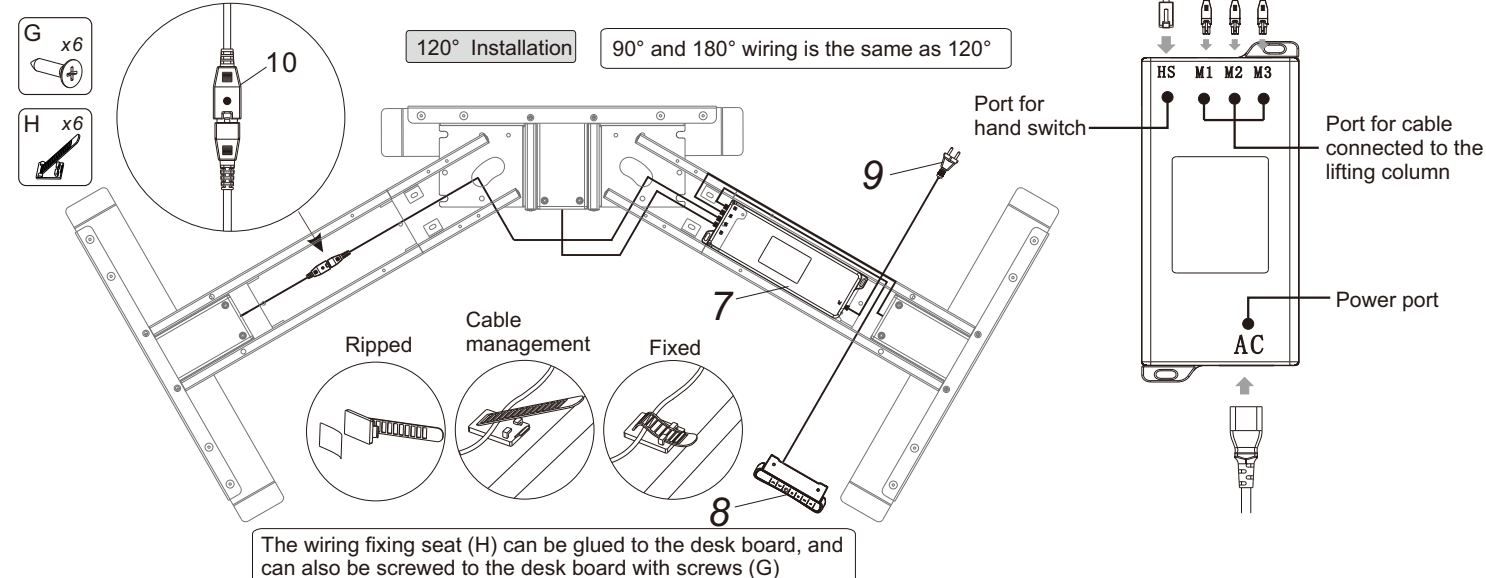

STEP 6-1

Install the Tabletop and Hand Switch



90° Installation

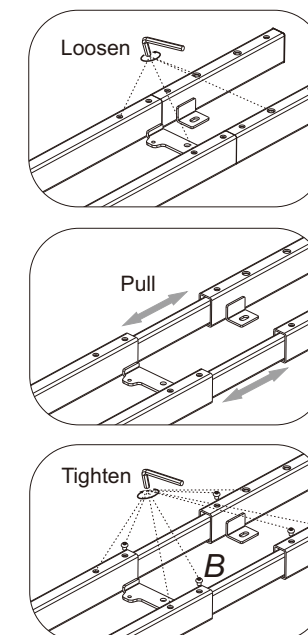
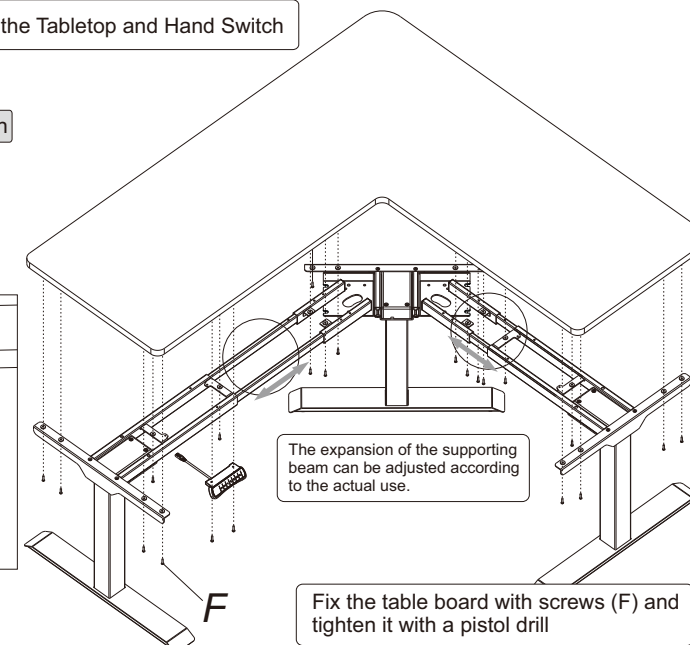
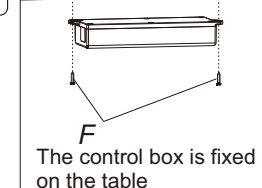

STEP 6-2

120° Installation

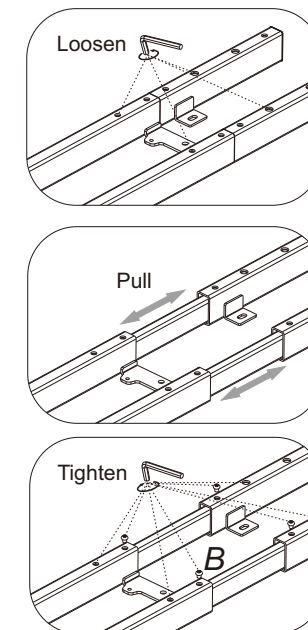
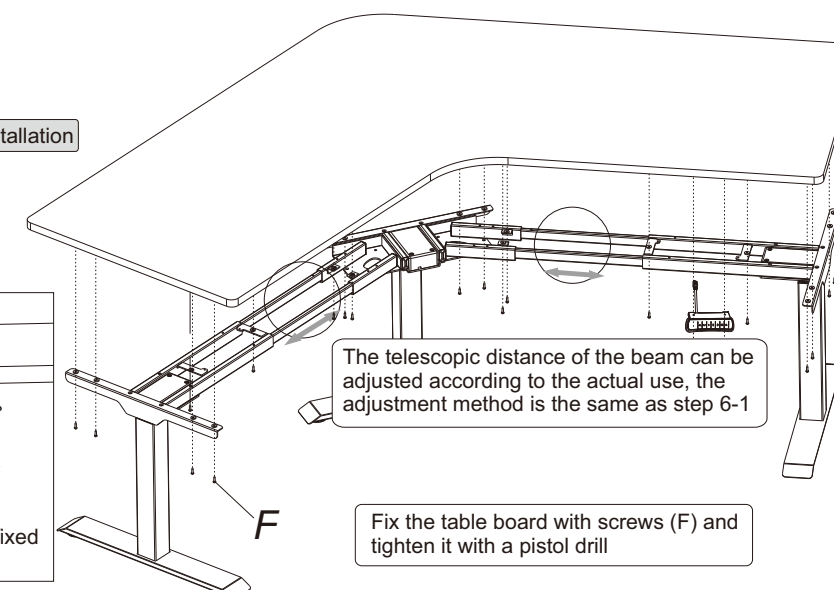
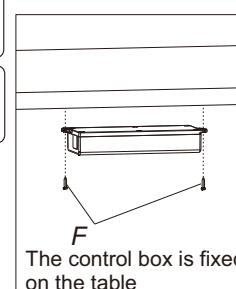

STEP 6-3

180° Installation

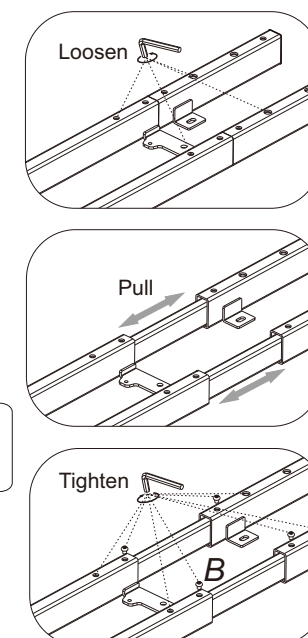
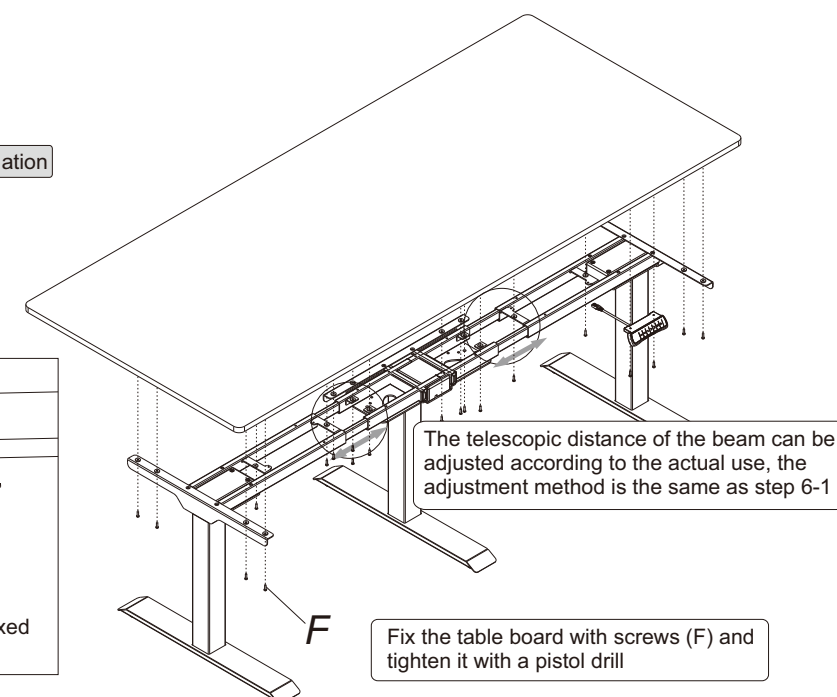
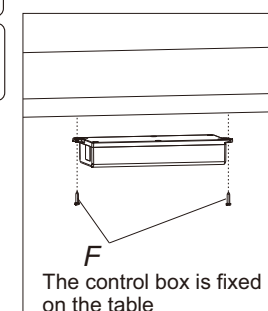

Common fault treatment

The following tips will help you detected and eliminate the common fault and error. If the fault you met is not listed below, please contact with your supplier. Only the manufacturer and professionals are capable for investigating and correcting those fault and error.

Fault phenomenon	Method
No response while long pressing down arrow after connected with a power supply	1. Check if all the cables be connected well
	2. Contact your supplier or dealer
No response while pressing up arrow/ down arrow after connected with a power supply	1. Check if all the cables be connected well
	2. Contact your supplier or dealer
Rising in a low speed	1. Check if overloaded, max loading: 150kg ;
	2. Contact your supplier or dealer
The motor not move as instructed	1. Contact your supplier or dealer
Go down but not go up	1.Reposition
	2.Contact your supplier or dealer
Downward sliding	1. Check if overloaded, max loading: 150kg ;
	2. Contact your supplier or dealer
Frequently Reposition	1. Check if overloaded, max loading: 150kg ;
	2. Contact your supplier or dealer
Overwork (Duty cycle : Max 2min on/18min OFF)	1. Restart after suspend for 18mins while connecting with power;
	2. Contact your supplier or dealer;
Not enough up&down height	1. Press "M"and "3" together for 3 seconds or more, after hearing continuous beeping for twice, it will restore factory settings
	2. Contact your supplier or dealer



Attention

1. Power supply: AC100V-240V,50/60Hz
2. Service Environment: 0-40℃
3. Unplug the power plug before cleaning, wipe the dust on surface with slight wet dishcloth when cleaning, be careful not to let the drops into the internal parts, not loose the connector.
4. The electric box contains electronic components, metals, plastics, wires etc., so dispose of it in accordance with each country's environmental legislation, not the general household waste.
5. Check carefully to ensure correct and complete assembly before using.
6. Be familiar with all functions and program settings of the product before first use.
7. Children are forbidden to play on the product because of unforeseen action when playing, so any dangerous consequences caused by this improper action will not be on manufacturers.
8. Slight noise caused by the V-ribbed belt or brake system due to structure will not have any effect on the use of the equipment.
9. Corrosive or abrasive materials are forbidden to clean the equipment. Must ensure that the cleaner used will not pollute the environment.
10. This appliance can be used by children aged from 8 years and above and persons with reduced physical, sensory or mental capabilities or lack of experience and knowledge if they have been given supervision or instruction concerning use of the appliance in a safe way and understand the hazards involved. Children shall not play with the appliance.
11. Cleaning and user maintenance shall not be made by children without supervision.
12. If the supply cord is damaged, it must be replaced by the manufacturer, its service agent or a similarly qualified person in order to avoid a hazard.
13. Please make sure there is no hazard sources in your operating environment. e.g., do not litter the tools around. Always be careful to treat the packaging materials in order to avoid any possible danger, e.g. plastic bag may lead to choking hazard to children.
14. Keep the original package of the equipment if necessary in case of the future use in transportation.

Waste disposal



This marking indicates that this product should not be disposed with other household wastes. To prevent possible harm to the environment or human health from uncontrolled waste disposal, recycle it responsibly to promote the sustainable reuse of material resources. To return your used device, please use the return and collection systems or contact the retailer where the product was purchased. They can take this product for environmental safe recycling.

Made in ChRL for
DMTrade Mikołaj Tomaszewski
Wiśniowa 36, 64-000 Kościan, Poland

NIP: PL6981681757
email: sklep@dmtrade.pl
phone #1: +48 661 082 052
phone #2: +48 726 082 052

www.ergoline.spacetronek.eu

DMTrade Mikołaj Tomaszewski declares that the devcie complies with the directives EMC (2014/30/EU), LVD (2014/35/EU), RoHS (2011/65/EU + 2015/864/EU).